

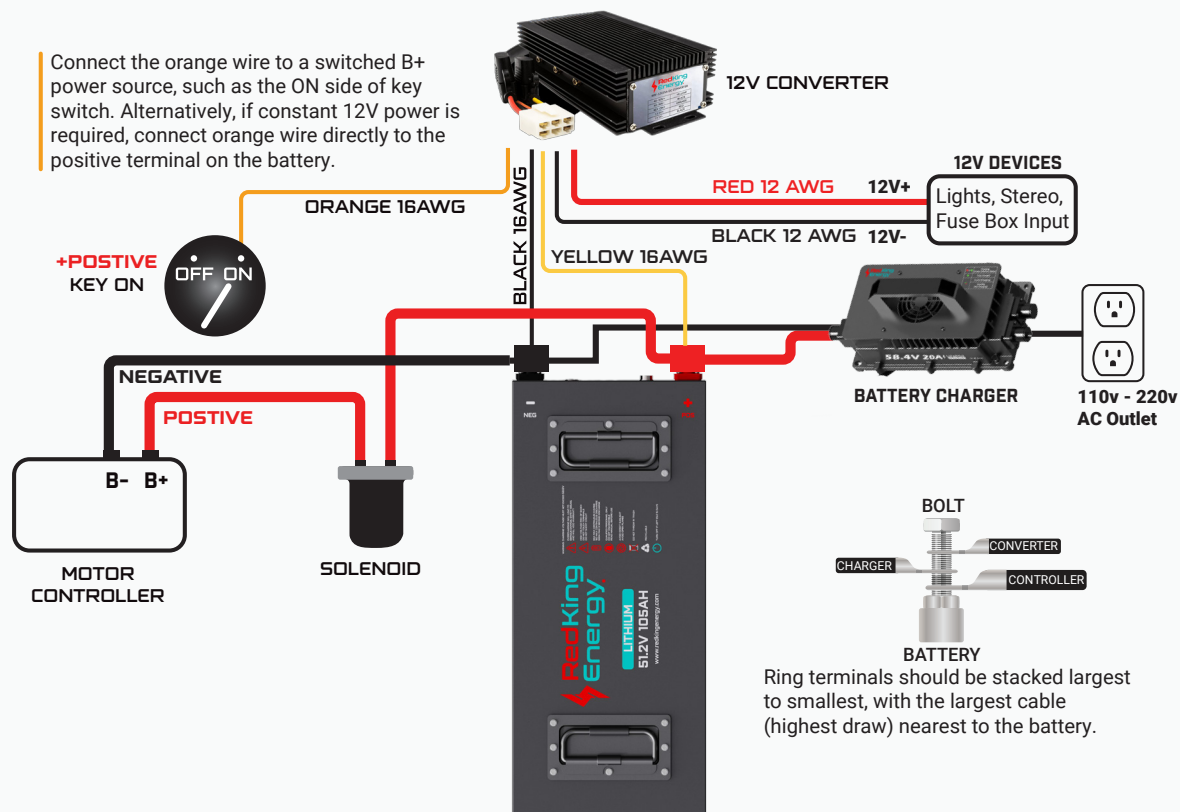

## GOLF CART BATTERY QUICK START DIAGRAM

info@redkingenergy.com  
RedKingEnergy.com



## WARNING!

Working with lithium batteries can be dangerous. Safety gear such as protective eyewear, insulated gloves, and insulated tools are required for safe installation.

This guide is not meant to give an untrained person enough knowledge to competently work with lithium batteries or electric vehicle systems.

If you do not fully understand this guide and are not trained to work with lithium batteries, please stop and seek professional installation.

Damage to the battery, system components, or property due to incorrect or improper installation is not covered by the warranty.

Important: inspect your new battery for any damage that may have occurred during shipping. If there are any visible signs of damage, do not continue and contact your dealer or RedKing Energy.